

# JETFLOW™ 3 CARTRIDGE

## 310 ML CARTRIDGE DISPENSER



Model shown: JetFlow 3 Cartridge 310 mL

### FEATURES

- Glass reinforced nylon handle
- Variable speed regulator
- Fitted as standard with a 6.8 bar (100 psi) regulator
- Front cap selector to change function
- Direct acting mechanism
- Built-in silencer (less than 70 dB)

### BENEFITS

- Ergonomically designed for comfort
- For precise control, smooth material flow
- Other options available
- Easily adjust between bead and spray with just one twist
- Air pressure applied direct to plunger
- Lowers the noise level

### APPLICATIONS



Bonding



Sealing

### PRODUCT BY RANGE



# THE JETFLOW 3 CARTRIDGE 1-COMPONENT PNEUMATIC DISPENSERS INNOVATIVE FRONT CAP DESIGN ALLOWS FOR QUICK CHANGE BETWEEN BEAD AND SPRAY FUNCTIONS.

## SPECIFICATIONS

- Weight: 1.22 kg / 2.7 lbs
- Barrel Length: 346.8 mm / 13.7 in
- Maximum Thrust: 1.45 kN
- Maximum Pneumatic Pressure: 6.8 bar (100 psi)
- Handle Material: Glass Filled Nylon
- Barrel Material: Anodized Aluminum
- Cartridge Capacity: 310 mL (10.5 oz)
- Standard Color: Black/Grey
- Customized versions on demand

## DIMENSIONS

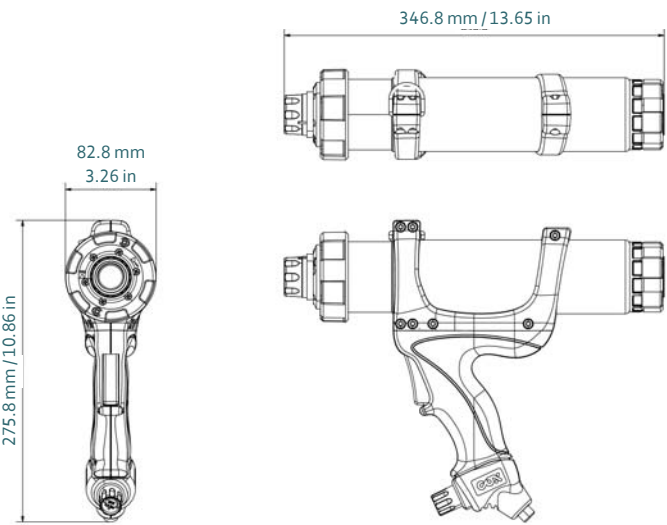

Product	Article number	Packaging
DP1C 310-ca-145-901	159352 (63007-300C for US)	1 per Box

## MATCHING MIXPAC™ CARTRIDGES

### COMPATIBLE CARTRIDGES

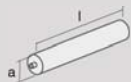

Plastic Cartridge  
310 mL HPDE/PP/PA

	mm	inch
l	216.0	8.5
a	Ø 48.2	Ø 1.8

## CONVERSION KITS

## MATCHING ACCESSORIES

Spray nozzles – 3 variants on pages 98–102.